



**570  
DOSES OF  
FOAM**

## SPORICIDAL FOAM

JET is a powerful sporicidal disinfectant that can be used on medical device surfaces located near to the patient.

JET is also a powerful cleaner destroying RNA and DNA in seconds. Its cleaning efficacy meets the requirements of a medical instrument cleaner, effectively reducing levels of protein and carbohydrate.

JET is the best safeguard for patients and staff wherever the risks of infection are highest. For use in areas such as patient wards, isolation wards, operating theatres, intensive care units, oncology wards and neonatal wards.

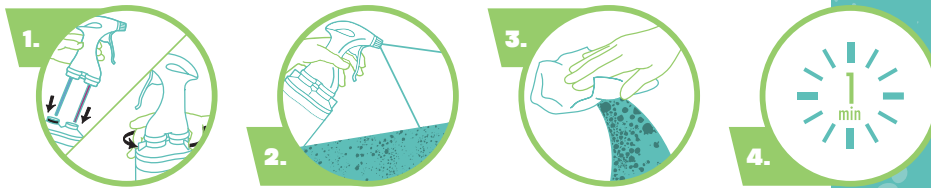

Effective against microorganisms of concern such as:

- *Clostridium difficile*
- Tuberculocidal mycobacteria
- Norovirus
- Influenza A virus (H1N1)
- Hepatitis B virus (HBV)
- Human immunodeficiency virus (HIV)
- Carbapenem-resistant Enterobacteriaceae (CRE)
- *Klebsiella pneumoniae*
- Methicillin-resistant *Staphylococcus aureus* (MRSA)
- Vancomycin-resistant Enterococci (VRE) *Enterococcus faecium*
- *Candida auris*
- *Escherichia coli*

### Complete compliance with EN 14885:

SPORES	EN 17126	YEASTS/FUNGI	EN 13624
	EN 13704		EN 14562
MYCOBACTERIA	EN 14348	BACTERIA	EN 16615
	EN 14563		EN 13727
VIRUS	EN 14476		EN 14561
	EN 16615		EN 16615



**1 UNIFORM CONTACT TIME  
OF ONE MINUTE**

**1ST LEVEL OF COMPLIANCE  
TO ALL APPLICABLE  
EN STANDARDS**

**1 ACTIVE INGREDIENT  
CHLORINE DIOXIDE**

**1 DISINFECTANT  
FOR ALL MEDICAL  
DEVICE SURFACES**

cache™

TRISTEL'S CLEANING AND DISINFECTION BRAND FOR HOSPITAL SURFACES

## POWERED BY CHLORINE DIOXIDE FOAM

JET is built upon the same core chlorine dioxide technology as the Tristel medical device disinfectant products, but specially adapted for surface disinfection where cleaning and biofilm destruction are so important.

Chlorine dioxide is widely regarded as one of the most effective disinfectants for biofilm removal and prevention.

JET delivers chlorine dioxide as a foam. It creates no aerosols when used.

## SAVING SPACE, REDUCING WASTE



3.5 Kilos

=



0.8 Kilos

Efficacy with the standard wipe in EN 16615 means JET can be used with any sustainably sourced wipe, avoiding the use and waste of plastic wipes.

## NEAR THE PATIENT WHERE JET WILL PROVIDE ITS GREATEST PROTECTION:

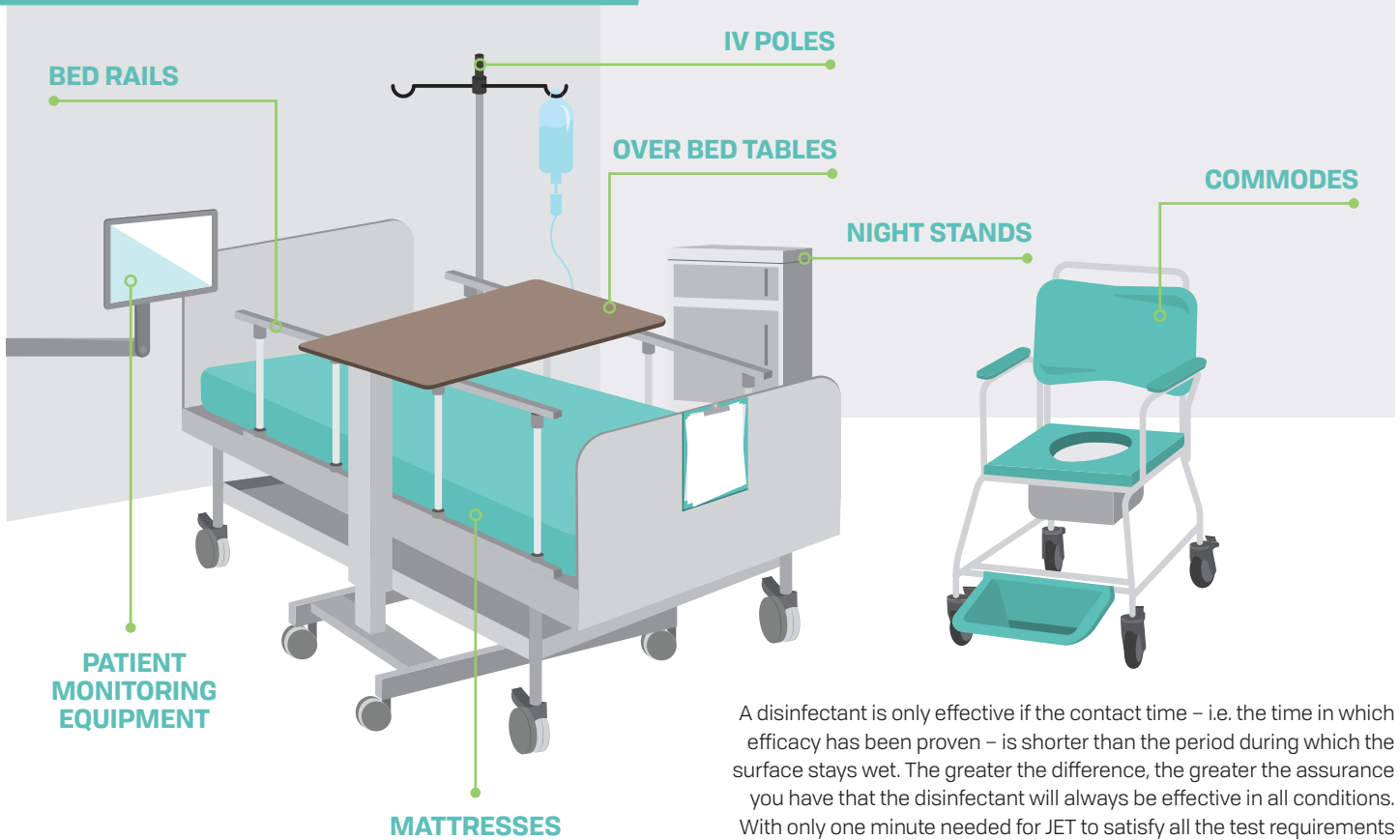

A disinfectant is only effective if the contact time – i.e. the time in which efficacy has been proven – is shorter than the period during which the surface stays wet. The greater the difference, the greater the assurance you have that the disinfectant will always be effective in all conditions. With only one minute needed for JET to satisfy all the test requirements of EN 14885:2018, JET gives you the highest level of assurance.



**AVAILABLE TO  
ORDER NOW!**

2 x 800ml JET per box

Quote: CCH010101

JET is CE marked as a Class IIa Medical Device in accordance with the European Medical Devices Directive 93/42/EEC and the 2007/47/EC amendments thereto.