

CLEARVUE

Daily Operation Guide

IT IS STRONGLY RECOMMENDED THAT YOU FOLLOW THIS
STEP-BY-STEP GUIDE TO SETTING UP AND OPERATING THE
CLEARVUE AUTOMATED COVERSLIPPER.

Part of Thermo Fisher Scientific









Thermo
SCIENTIFIC

Thermo Fisher Scientific, Anatomical Pathology, 93-96 Chadwick Road, Astmoor, Runcorn, Cheshire, WA7 1PR, UK
Tel: +44 (0) 1928 562 600 Fax: +44 (0) 1928 562 627 Web: www.thermo.com/pathology

A79210120 - Iss 5

2

Daily Tasks

-  Top up the Dispense Head Cleaning Station
-  Wipe the top of the Cleaning Station with a xylene damp cloth
-  Top up the Xylene Tray
-  Check the number of Coverslips in Hopper
-  Check level of Mountant and top up if necessary
-  Check the Suction Cup is clean and free from debris
-  Purge the system 3 times - lift the Coverslip Hopper before purging
-  Clean the Gripper Return Plate

1

Safety

Please read and understand the following information before setting up or operating the ClearVue Automated Coverslipper.

The following symbols and conventions are used throughout this document and on the instrument.



THIS SYMBOL IS USED ON THE EQUIPMENT, OR IN A DOCUMENT, TO WARN THAT INSTRUCTIONS MUST BE FOLLOWED FOR SAFE AND CORRECT OPERATION. IF THIS SYMBOL APPEARS ON THE INSTRUMENT, ALWAYS REFER TO THE RELEVANT SECTION IN THE DOCUMENTATION.



THIS SYMBOL IS USED ON THE EQUIPMENT, OR IN A DOCUMENT, TO WARN THAT THERE MAY BE A BIOHAZARD ASSOCIATED WITH THE INSTRUMENT. ALWAYS ACT WITH COMMON SENSE AND BE AWARE OF THE SAMPLES USED. TAKE SUITABLE PRECAUTIONS.



THIS SYMBOL IS USED ON THE EQUIPMENT, OR IN A DOCUMENT, TO WARN THAT HARMFUL CHEMICALS ARE USED WITH THE INSTRUMENT. REFER TO THE MATERIAL SAFETY DATA SHEETS FOR THE CHEMICALS USED. ALWAYS ACT WITH COMMON SENSE AND BE AWARE OF LOCAL LABORATORY PROCEDURES. TAKE SUITABLE PRECAUTIONS.

A warning is given in the document if there is a danger of personal injury or damage to samples or equipment.

Note

Notes give more information about a job or instruction but do not form part of the instructions.

Due care and good laboratory practice must be employed when dealing with chemicals.

Be aware that many of the reagents used with the ClearVue are flammable. - Do not introduce any source of ignition into, or near, the instrument once it has been loaded with reagents.

The ClearVue coverslipper weighs approximately 45 kg (100 lb) and requires more than one person to lift it.

Do not remove any panels or covers - The ClearVue does not have any user serviceable parts inside the instrument.

This instrument must be properly connected to a good earth (Ground) via the mains input supply.

Position the ClearVue such that it is possible to interrupt the Mains supply at the source by removing the plug from the socket.







Make sure that there is at least 100 mm (4 in) clearance around the fan inlet on the back of the instrument.

If this equipment is used in a manner not specified by Thermo Fisher Scientific, the protection offered by the equipment may be impaired.

Before operating the ClearVue, it is recommended that the Safety Section of the Safety and Warranty Booklet (A79910001) should be read and understood.

3

Weekly Tasks

-  Empty, clean and refill the Dispense Head Cleaning Station
-  Remove any glass debris from the Slip Dispense Area
-  Remove the Transfer Head and check that the Pads and Suction Cup are free of Mountant and debris
-  Empty the Debris Tray
-  Check the Purge Tray and replace if necessary
-  Wipe the Slip Dispense Skirt

4

Changing the Carbon Filter

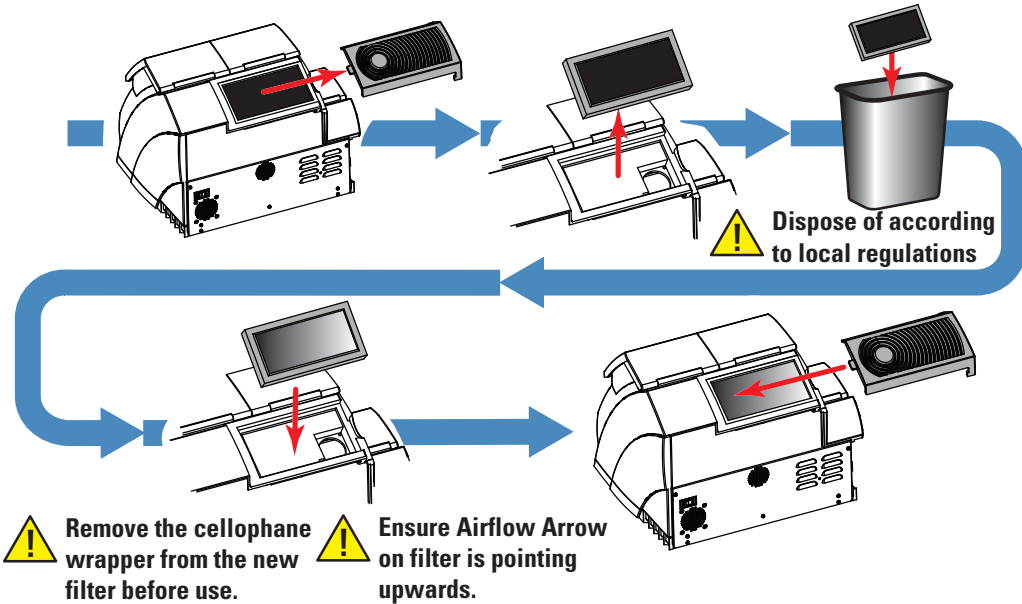

6

Filling the Mountant Bottle

Twist the top of the Mountant Bottle anti-clockwise to loosen it.

Remove the top of the Mountant Bottle.

Carefully pour mountant into the bottle until it reaches the required level.

✗ Harmful Chemicals

Replace the Mountant Bottle top and twist clockwise to tighten it.

! Hand tighten only - Do not use any mechanical device.

! The Mountant Bottle must be De-Gassed every time it is filled (see Step 10).

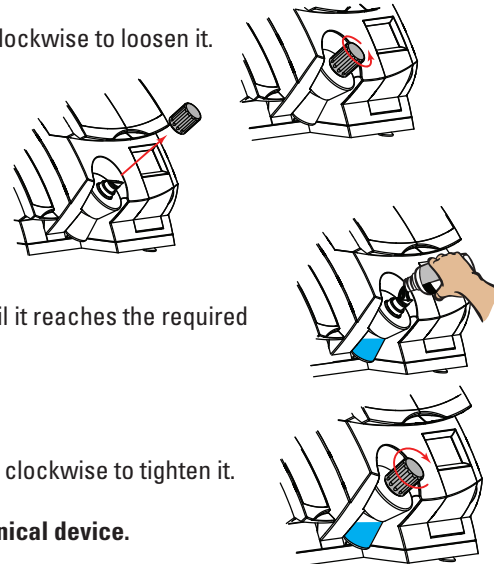

5

Filling the Xylene Tray

! **✗** Xylene

Pull the Xylene Tray out about half-way, taking care not to spill any remaining Xylene.

Carefully pour Xylene into the Xylene Tray.

Do not fill above the level of the top of the Anti-Surge Baffle.

Carefully push the Xylene Tray back in until it is fully closed and the seal is made.

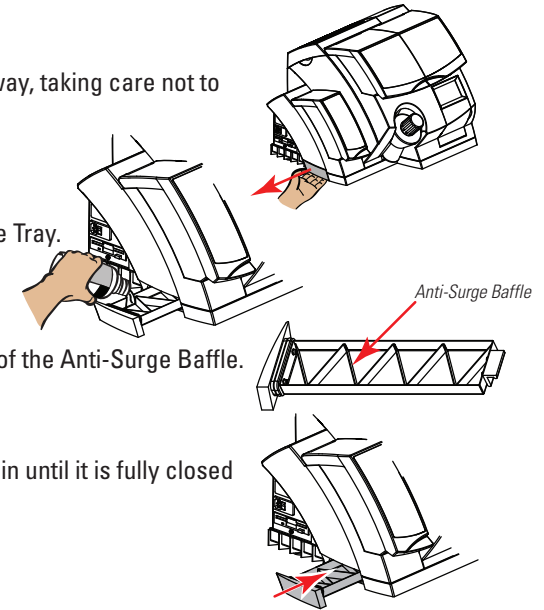

7

Changing the Purge Tray

Open the Debris Tray Access Door.

Remove the Debris Tray and empty if necessary.

! Broken glass

Use the tab to lift out the Purge Tray.

Dispose of according to local regulations.

✗ Harmful Chemicals

• Empty the Purge tray.

or

• Unpack a new Coverslip Hopper and remove the end cap - this doubles as a new Purge Tray.

Note:

To replace the Purge Tray, follow the above procedure in reverse.



8

Start Up Procedure

Turn the Mains Power Switch to the 'ON' position.

Note: Lift the Coverslip Hopper before turning the power on.



Mains Power Switch

Turn the Battery Switch to the 'ON' position.



Battery Switch

When the Language Select screen appears, use the and keys on the Touch Screen

to highlight the required language, and then press .

The ClearVue will initialize for about 1½ minutes and then the Main Menu will be displayed.

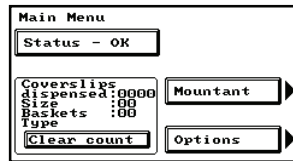

9

Filling the Cleaning Station

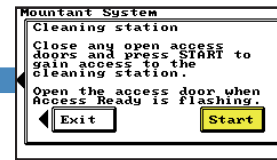
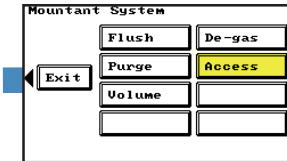
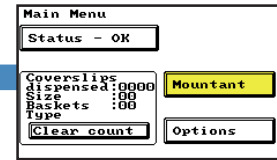

Wait for instrument activity to stop

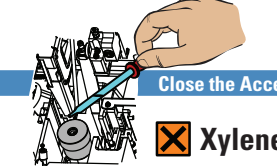
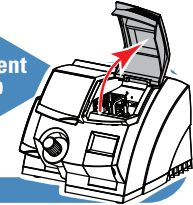

Close the Access Door

Xylene



10

De-Gas the Mountant Bottle

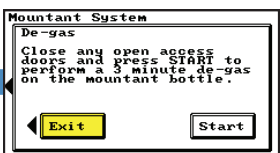
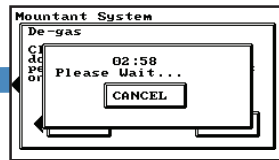
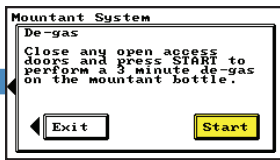
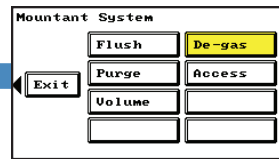
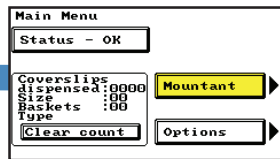

The Mountant Bottle must be de-gassed every time it is filled

11

Flushing the System

Lift the Coverslip Hopper before flushing the system.

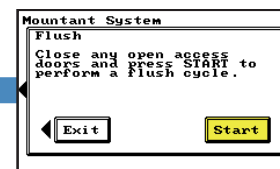
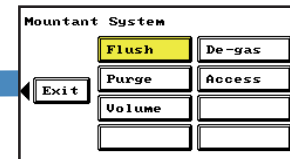
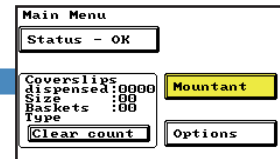

Wait for instrument activity to stop

Empty the Purge Tray as described in Step 7



Flushing the system uses a large volume of mountant but will ensure that there is no air in the system.

12

Purging the System

Lift the Coverslip Hopper before purging the system.

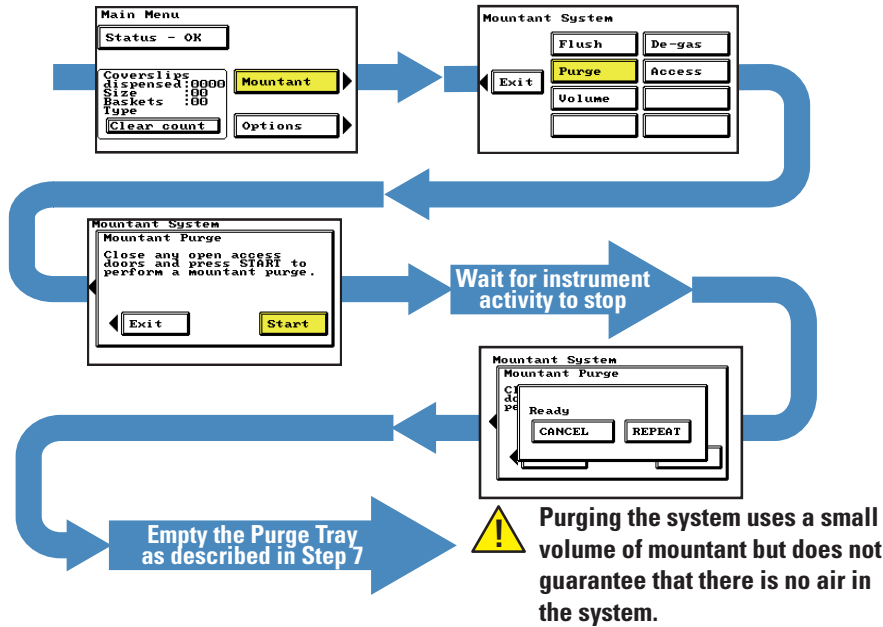

13

Changing the Coverslip Hopper

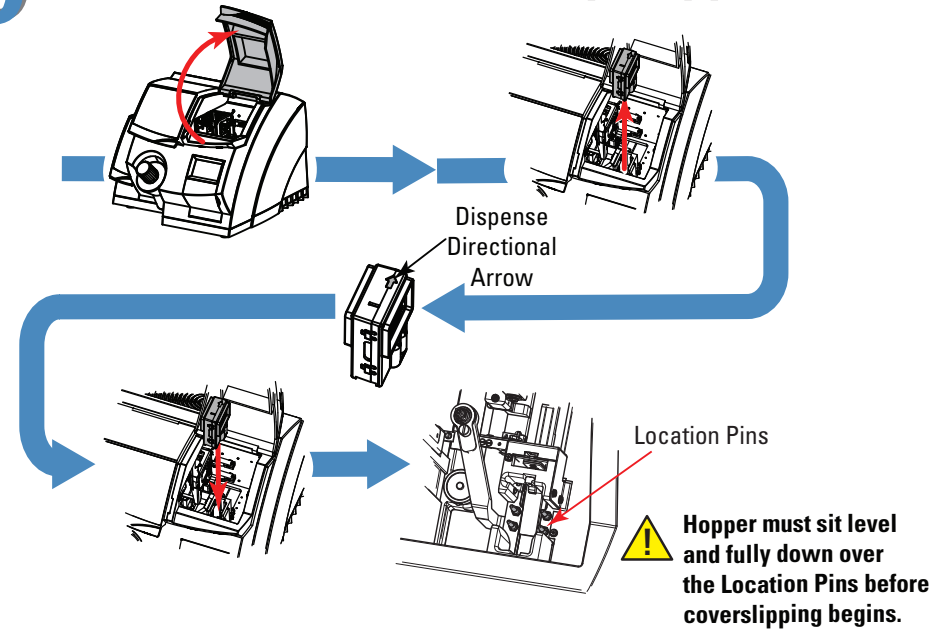

14

Loading Baskets

Gently shake each basket to remove excess xylene and blot on absorbant paper before placing onto the load rail.

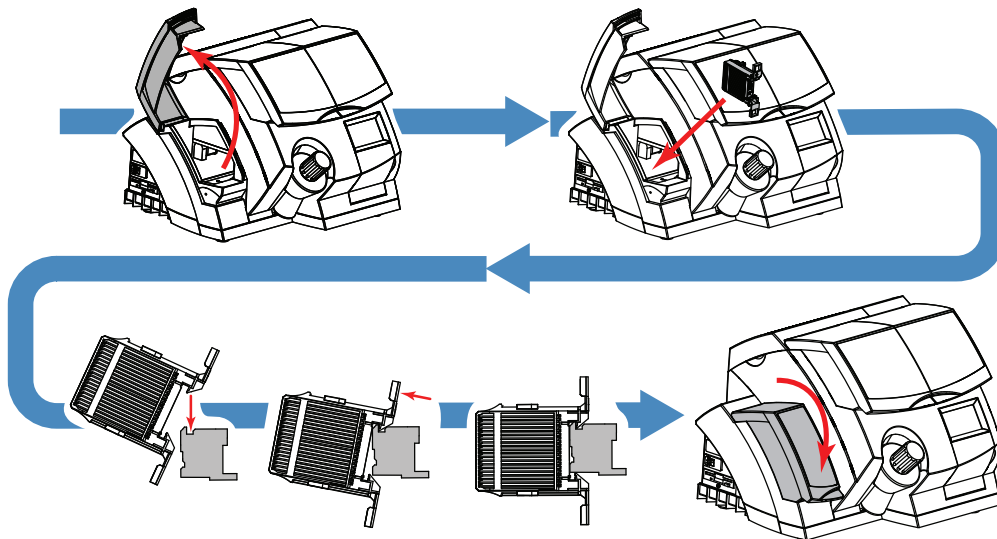

15

Unloading Baskets

