

## Rotor A-8-17 for the Centrifuge 5702 / 5702 R – Instructions for use

These instructions for use for the rotor A-8-17 are a supplement to the operating manual for the centrifuge and are not a substitute. Read the operating manual before using the rotor for the first time. The current version of the operating manual can be found on the Internet at [www.eppendorf.com](http://www.eppendorf.com).

The swing-bucket rotor A-8-17 can be loaded with 15 ml Falcons® and 15 ml DIN tubes of DURAN glass. The maximum permissible tube length is 120 mm. The maximum load capacity (adapter, tube and contents) of the rotor is 8 x 38 g.

When fitting the rotor, please note the nut on the underside of the rotor. To insert the rotor, rotate the driver pin of the motor shaft lengthwise. Place the rotor onto the motor shaft in such a way that the nut points in the same direction as the driver pin of the motor shaft. Tighten the rotor nut with the rotor key by turning in a clockwise direction. If the rotor cannot be tightened without difficulty, please ascertain that the rotor has caught the driver pin of the motor shaft.

To loosen the rotor, rotate the rotor nut counter-clockwise with the rotor key.

Insert the provided plastic adapter (Order no. 5702 702.005) into the sleeves prior to centrifugation of the Falcons. This prevents the Falcons from being destroyed. Round rubber plates (Order no. 5702 701.009) are required for the centrifugation of DIN tubes in order to prevent them from bursting.

Please make certain prior to centrifugation that such a rubber plate is beneath each glass tube. Please observe the maximum RCF specified by the manufacturer for the tubes used.

When not loading the rotor completely, please be sure to load the rotor in such a way that the pegs are loaded symmetrically.

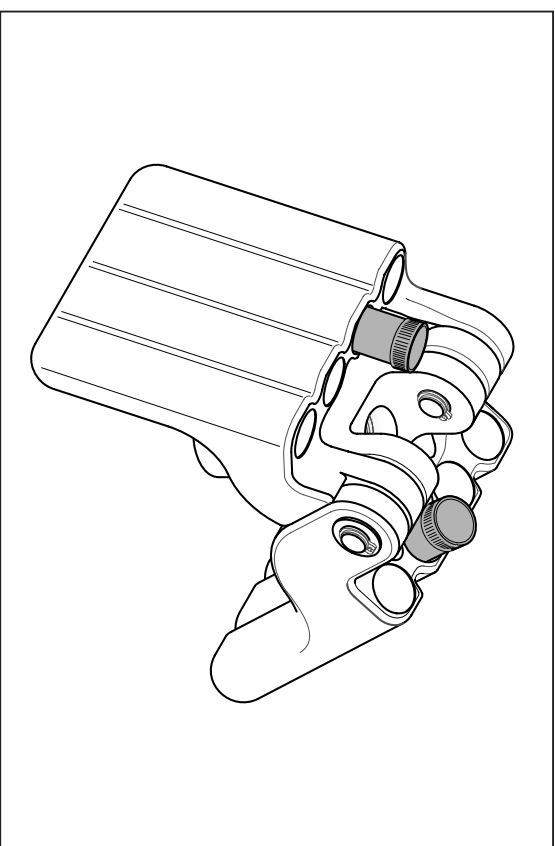

# eppendorf

*In touch with life*

Your local distributor: [www.eppendorf.com/worldwide](http://www.eppendorf.com/worldwide)

Eppendorf AG · 22331 Hamburg · Germany · Tel. +49 40 538 01-0 · Fax +49 40 538 01-556 · E-Mail: [eppendorf@eppendorf.com](mailto:eppendorf@eppendorf.com)  
Eppendorf North America, Inc. · One Cantigue Road, P.O. Box 1019 · Westbury, N.Y. 11590-0207 USA · Tel. +1 516 334 7500 · Toll free phone 800 645 3050 · Fax +1 516 334 7506 · E-Mail: [info@eppendorf.com](mailto:info@eppendorf.com)

### Application Support

Europe, International: Tel. +49 1803 666 789 · E-Mail: [support@eppendorf.com](mailto:support@eppendorf.com) · North America: Tel. +1 800 645 3050 ext. 2258 · E-Mail: [support\\_NA@eppendorf.com](mailto:support_NA@eppendorf.com)  
Asia, Pacific: Tel. +603 8023 2769 · E-Mail: [support\\_Asia@eppendorf.com](mailto:support_Asia@eppendorf.com)