

Fixed angle rotor FA-45-18-11 for Centrifuge 5418 – Instructions for use

This supplement sheet does not replace the operating manual for the centrifuge.

Read this supplement sheet and the operating manual for the centrifuge before using the rotor for the first time.

Introduction

The FA-45-18-11 is an aerosol-tight¹ fixed angle rotor designed for centrifugation of 18 micro test tubes with a fill volume of up to 2.0 ml in the Centrifuge 5418.

The FA-45-18-11 can be operated with or without the rotor lid:

- Without a rotor lid, the rotor is not aerosol-tight. The rotor lid is not essential for standard operation.
- The rotor lid must be securely locked for aerosol-tight centrifugation.
Spin Columns must always be centrifuged with the rotor lid.

The centrifuge 5418 with this rotor is intended for sample preparation in clinical diagnostics as well as in routine, training and research laboratories in clinics, science and industry.

Centrifuging with the rotor lid

When using the rotor lid always centrifuge with the sealing ring. Operating the centrifuge with the rotor lid but without the sealing ring is not permitted.

Safe centrifugation is guaranteed and leakage of aerosols prevented reliable, only if rotor lid and sealing ring are used together.

1. Before centrifuging tubes, ensure that these have been correctly closed in accordance to the instructions.
2. Check before centrifuging with rotor lid that the sealing ring is fitted properly in the groove.
3. Fit the rotor lid vertically on the rotor.
4. Lock the rotor by turning the rotor lid screw clockwise beyond an audible "click" until it can be turned no further.

The rotor is not properly closed until the audible "click" is heard!



The rotor lid can loosen if handled incorrectly.

- ▶ **Never hold or transport the closed rotor by the rotor lid screw.**

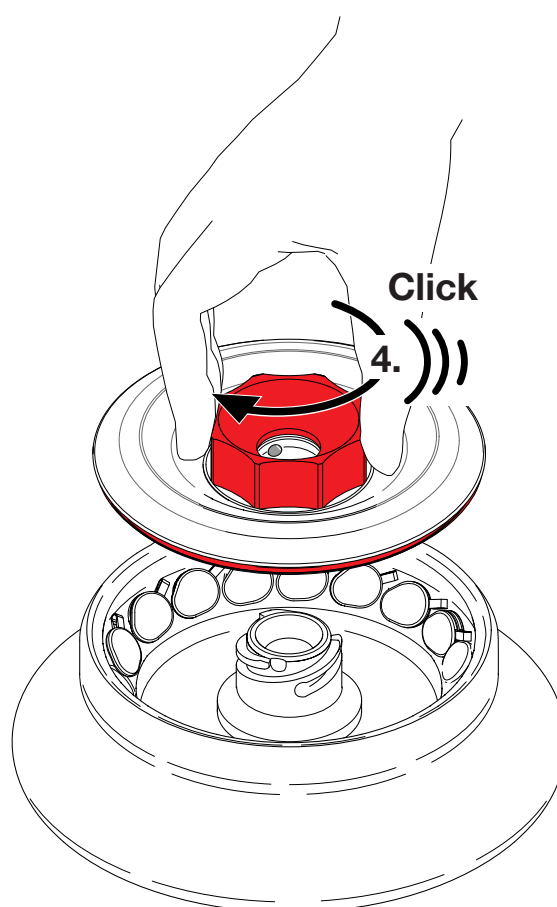

1. Aerosol-tightness tested and certified by the Centre of Emergency Preparedness and Response, Health Protection Agency, Porton Down (UK).

Fixed angle rotor FA-45-18-11 for Centrifuge 5418 – Instructions for use

Cleaning

Use mild cleaning agents to clean the rotor and the rotor lid.
Disinfect with alcohol (ethanol, isopropanol) or alcohol-containing disinfectants.

1. Clean and disinfect the rotor.
2. Clean and disinfect the rotor lid.
When cleaning, the sealing ring must be removed (see fig.) so that the groove can also be cleaned thoroughly.
3. Ensure that the sealing ring is fitted properly in the clean, dry groove before using the centrifuge again.

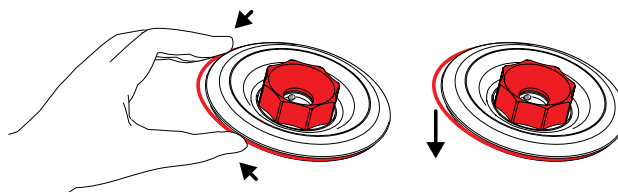

The rotor and the rotor lid can be autoclaved (121 °C, 20 min).

The sealing ring must be replaced at the latest after it has been autoclaved 10 times.



Apply a thin coating of pivot grease to the pins in the rotor lid screw after each cleaning, after each autoclaving (121 °C, 20 min) and in the event of sluggish activation of the locking system.

Period of use

The maximum period of use for the rotor lid is 3 years from initial commissioning.
Requirement: The "click" is still audible when tightening the rotor lid screw.

There is no limit on the period of use for the rotor under the following conditions:

- The device is undamaged
- The device is used correctly
- The device is maintained as recommended

Ordering information

	Order no.	
	International	North America
Rotor FA-45-18-11 with rotor lid, Aluminum, aerosol-tight, angle 45°, 18 places, max. diameter 11 mm to accommodate 1.5/2.0 ml micro test tubes	5418 707.005	022652109
Spare lid (aluminum) for rotor FA-45-18-11, aerosol-tight	5418 708.001	022652125
Spare seal for rotor lid FA-45-18-11, 5 pcs	5418 709.008	022652141
Pivot grease	5810 350.050	022634330

eppendorf

In touch with life

Your local distributor: www.eppendorf.com/worldwide

Eppendorf AG · Germany · Tel. +49 40 538 01-0 · E-Mail: eppendorf@eppendorf.com

Eppendorf North America, Inc. · USA · Toll free phone 800 645 3050 · E-Mail: info@eppendorf.com

Application Support

Europe, International: support@eppendorf.com · North America: support_NA@eppendorf.com

Asia, Pacific: support_Asia@eppendorf.com